

# Sensor Kit

Part # 980608 for use with ARSS, ARSS-LD Controls and Premium Water Saving Package (Part # WSP)

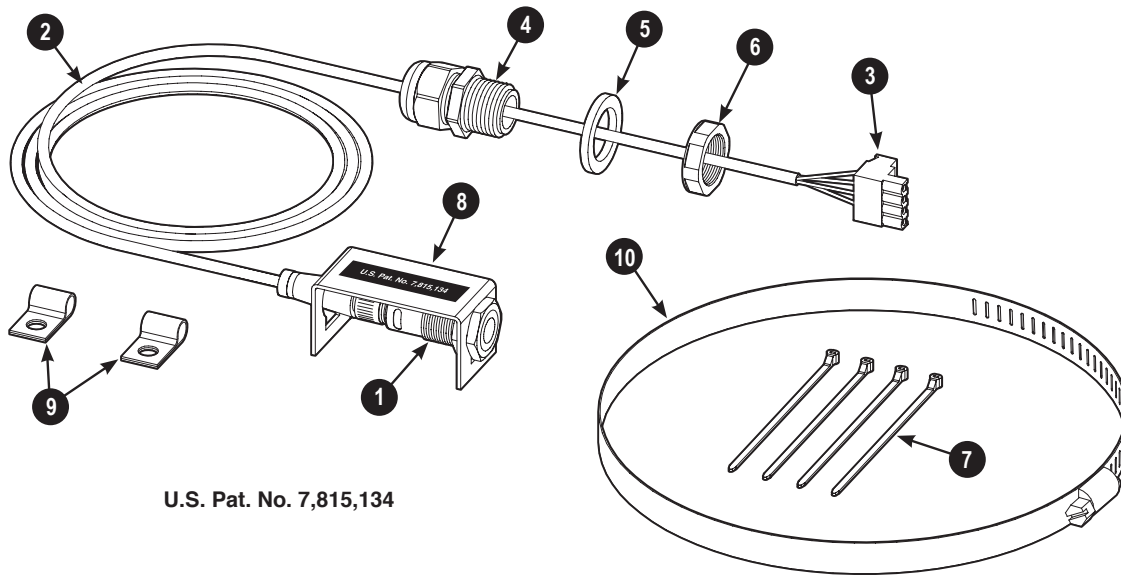

U.S. Pat. No. 7,815,134

## Parts List

ITEM #	QTY	PART #	DESCRIPTION
1	1	994390	Sensor Proximity Ultrasonic
2	1	994402	Cordset for Proximity Sensor 4P
3	1	994401	Plug Female Term Block (Orange)
4	1	994403	Cord Connector 1/2" NPT
5	1	HYCSW5	Washer Sealing 1/2"
6	1	994179	Locknut 1/2" Heyco
7	4	TY523M	Cable Tie Small Clear
8	1	982329	Sensor Bracket ARSS
9	2	994404	Sensor Cord Wire Clamp
10	1	M128	Clamp Disposer Hycar Bottom SS

## 2 Attaching the Sensor

## 3 Electrical Connections & Board Configuration

## 4 Operating Instructions (Control with Sensor)

**ALL INSTALLATIONS SHOULD BE MADE IN ACCORDANCE WITH LOCAL AND NATIONAL PLUMBING AND ELECTRICAL CODES.**

# SALVAJOR®

Manufacturers of Commercial Food Waste Solutions - Since 1944

4530 East 75th Terrace Kansas City, MO 64132-2081, USA

Toll Free: 1.888.725.8256 | Fax: 1.800.832.9373

service@salvajor.com | [www.salvajor.com](http://www.salvajor.com)

Installation & Operating  
INSTRUCTIONS

## ATTACHING THE SENSOR

1. Thread on one of the sensor locknuts until it is approximately 3/8" from the end of the Sensor (1). Insert sensor into Sensor Bracket (8) as shown. Indicator light should face up. Secure with second locknut. **DO NOT OVER TIGHTEN.** Attach Cordset (2) to sensor. **(See Fig. 1)** Run Clamp (10) through sensor bracket. Clamp should rest in the notch of the bracket as shown. **(See Fig. 2)**

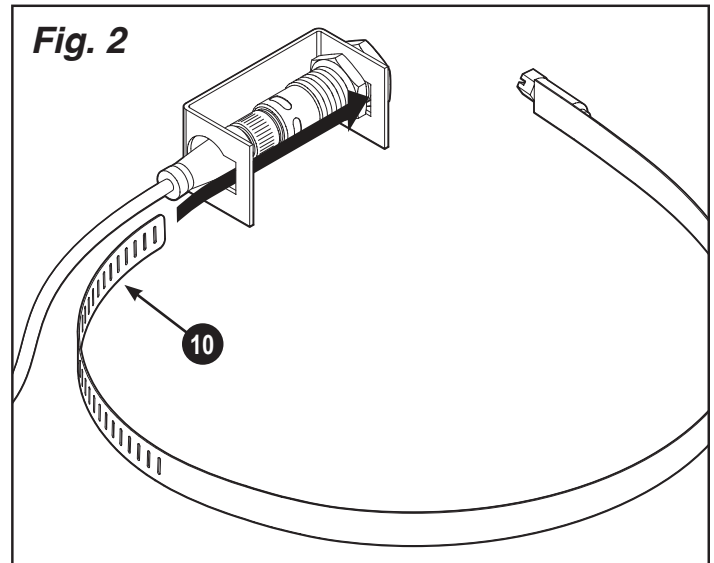
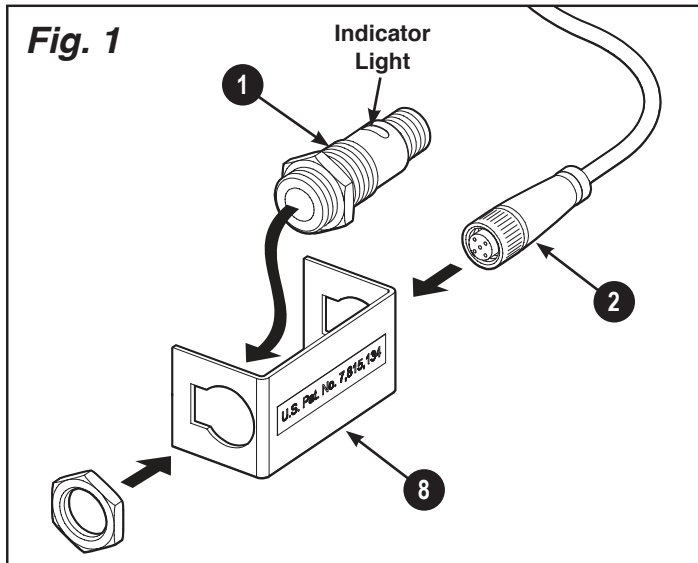

2. Attach clamp between the two existing clamps of the rubber hycar adaptor. Tighten clamp to secure sensor in place. **(See Fig. 3)**

**Note:** The sensor can be mounted on either side of the disposer. The sensor should point towards the operator and have an unobstructed view. **(See Fig. 4)**

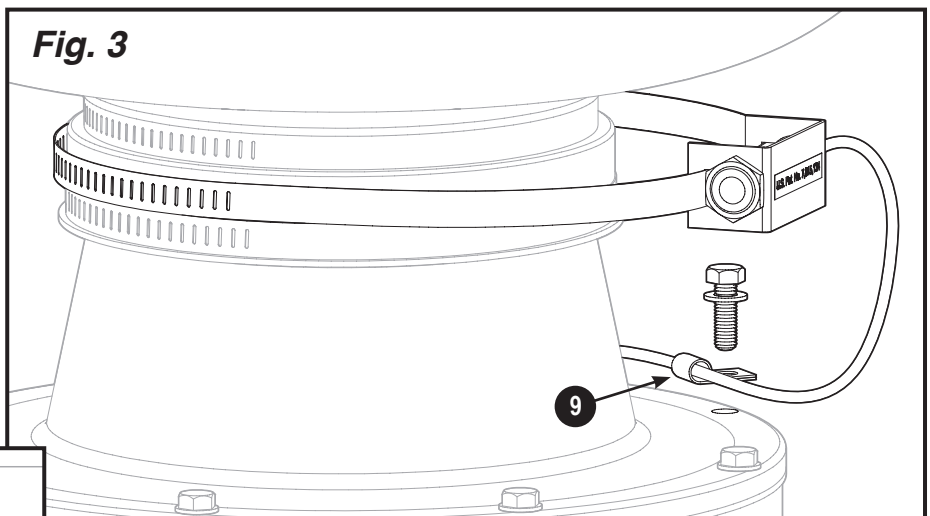

3. Wire Clamps (9) are supplied to secure sensor cord to top of disposer if needed. Attach as shown. **(See Fig. 3)** If needed, a second wire clamp can be used if cord runs behind disposer. Included Cable Ties (7) can also be used to secure sensor cord if needed.

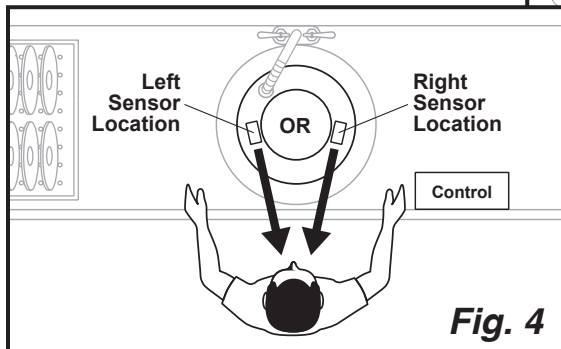

**ALL INSTALLATIONS SHOULD BE MADE IN ACCORDANCE WITH  
LOCAL AND NATIONAL PLUMBING AND ELECTRICAL CODES.**

## ELECTRICAL CONNECTIONS

### WARNING: ELECTRICAL SHOCK HAZARD

Turn off all electrical supply to the panel before proceeding to next step.

1. Remove and discard watertight plug from unused hole in bottom of control panel. From below, insert Cord Connector (3) into hole in bottom of control panel. Place Sealing Washer (4) over end of cord connector. Tighten Locknut (5) to secure connector. Run Cord (2) through cord connector. (See Fig. 5)
2. Strip each colored wire back 3/16". Connect colored wires to Terminal Plug (6) as shown. Plug the terminal plug into board. (See Fig. 6)
3. Tighten nut on cord connector to secure cord in place.

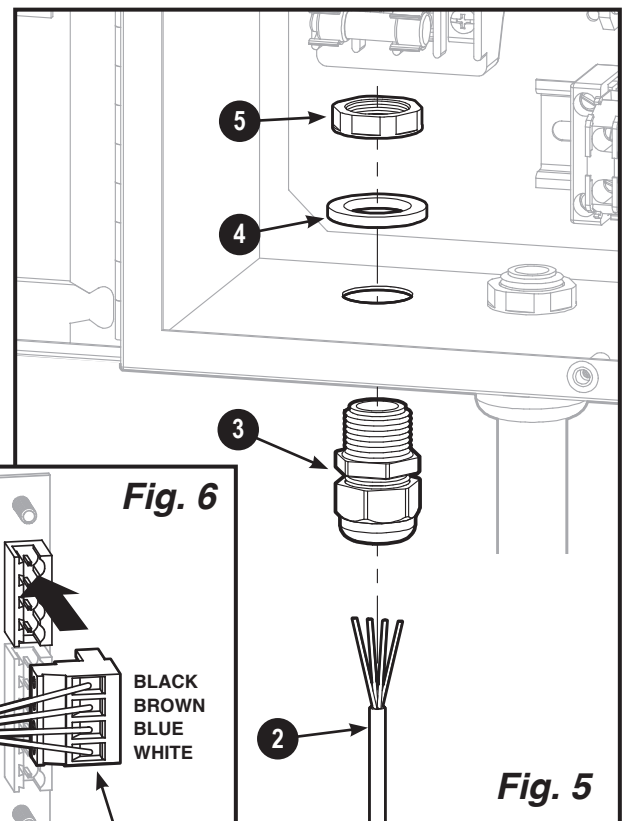
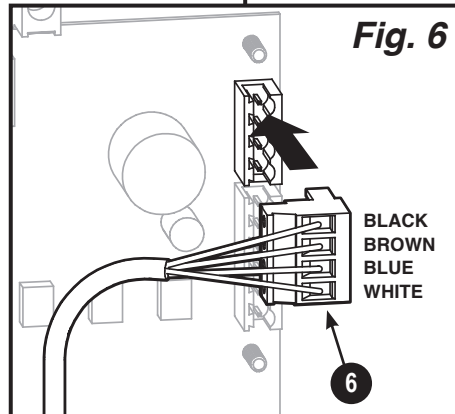

Note: Some wiring and details omitted from illustrations for clarity.

## HYDROLOGIC® CONTROL BOARD CONFIGURATION

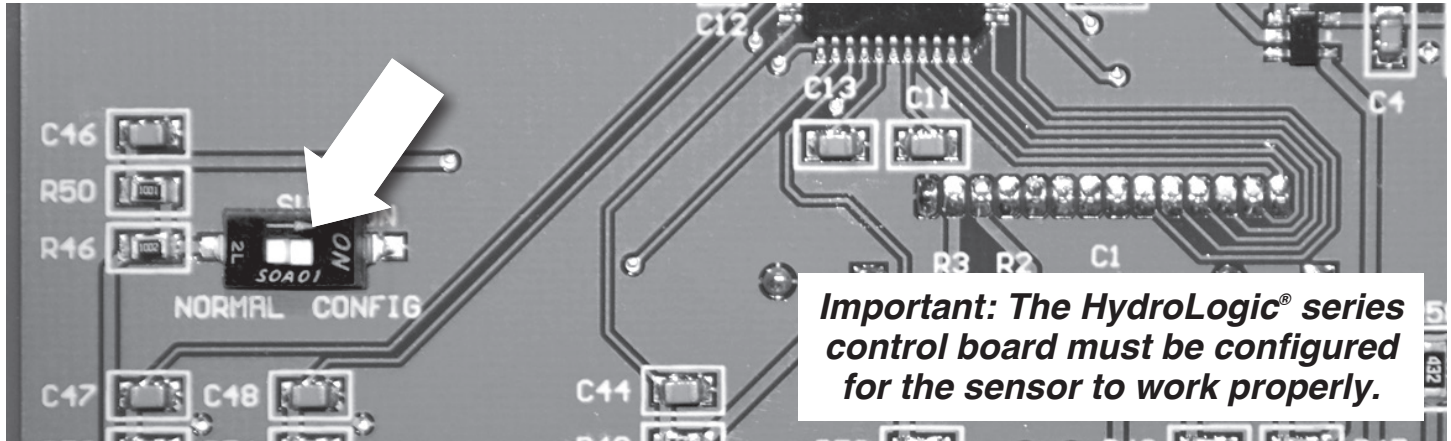

Open the control box and locate the configuration switch in the upper left side of the control board. Move switch to the CONFIG position.

With the board powered, the screen on the front will read CONFIGURATION MENU with the software version #.

Press **+** to advance to DEVICE SELECTION. Press **ON/OFF** to enter DEVICE SELECTION.

Press **+** or **-** to display: **DISPOSER w/PROX**

With **DISPOSER w/PROX** displayed, press **ON/OFF** to save and exit DEVICE SELECTION. Move the configuration switch to the NORMAL position and close the control box.

### Verify control is in the correct mode.

With the control off, press the **ON/OFF** button. The readout will display version and configuration.

# OPERATING INSTRUCTIONS

## ARSS & ARSS-LD Disposer Control with Operator Sensor

### Choose mode of operation

(If equipped, verify Line Disconnect is in the ON position)

#### Standard ON/OFF Mode

(ON/OFF light will be off.)



1. Press the START button. The display will read "SYSTEM ON".
2. To stop the Disposer, press the STOP button.

#### Water Saver Mode

1. Press the START button. The display will read "SYSTEM ON".
2. Press the  button. The ON/OFF light will illuminate. (An \* appears in the upper left corner of the display when the operator is in range of the sensor.)



When the operator steps away from the disposer

for several seconds the display will read "RUN TIME", a timer will count down, and water flow will be reduced to the disposer. If the operator does not return to the disposer before the timer reaches 0, the disposer will turn off. The run time can be adjusted by pressing the  for more time or  for less time. If the operator returns to the disposer before the timer reaches 0, the control will return to "SYSTEM ON", water flow to the disposer will return to normal, and the timer will reset.

To restart the disposer after the timer reaches 0, press the START button.

3. To stop the disposer, press the STOP button.